

Up River
 S. 29. E. 56.
 S. 2 1/4. E. 16.
 S. 23. W. 30.6
 S. 31 1/4. W. 33.
 S. 57 1/2. W. 26.8
 S. 85. W. 118.
 West 20.
 S. 56. W. 14.
 S. 50. W. 12.
 S. 2 1/2. W. 10.
 South 13.
 S. 40 1/4. W. 40.
 S. 6 1/4. W. 28.
 S. 16 1/4. W. 17.
 S. 36 1/4. W. 12.
 S. 20 1/4. W. 11.
 S. 6 1/4. W. 12.
 S. 13 1/4. E. 8.5
 S. 15. E. 26.
 S. 6 1/2. E. 37.3
 S. 81. E. 61.
 N. 75 1/2. E. 27.
 S. 83. E. 91.
 S. 22. E. 40.
 S. 5. E. 45.
 S. 13. W. 24.
 S. 30. W. 89.
 S. 11 1/4. W. 32.
 S. 15. E. 28.
 S. 6. E. 90.
 S. 8 1/4. E. 16.
 S. 8 1/4. W. 78.
 S. 30 1/4. W. 88.
 S. 52 1/2. W. 174.
 S. 48 1/2. W. 67. to Rock *

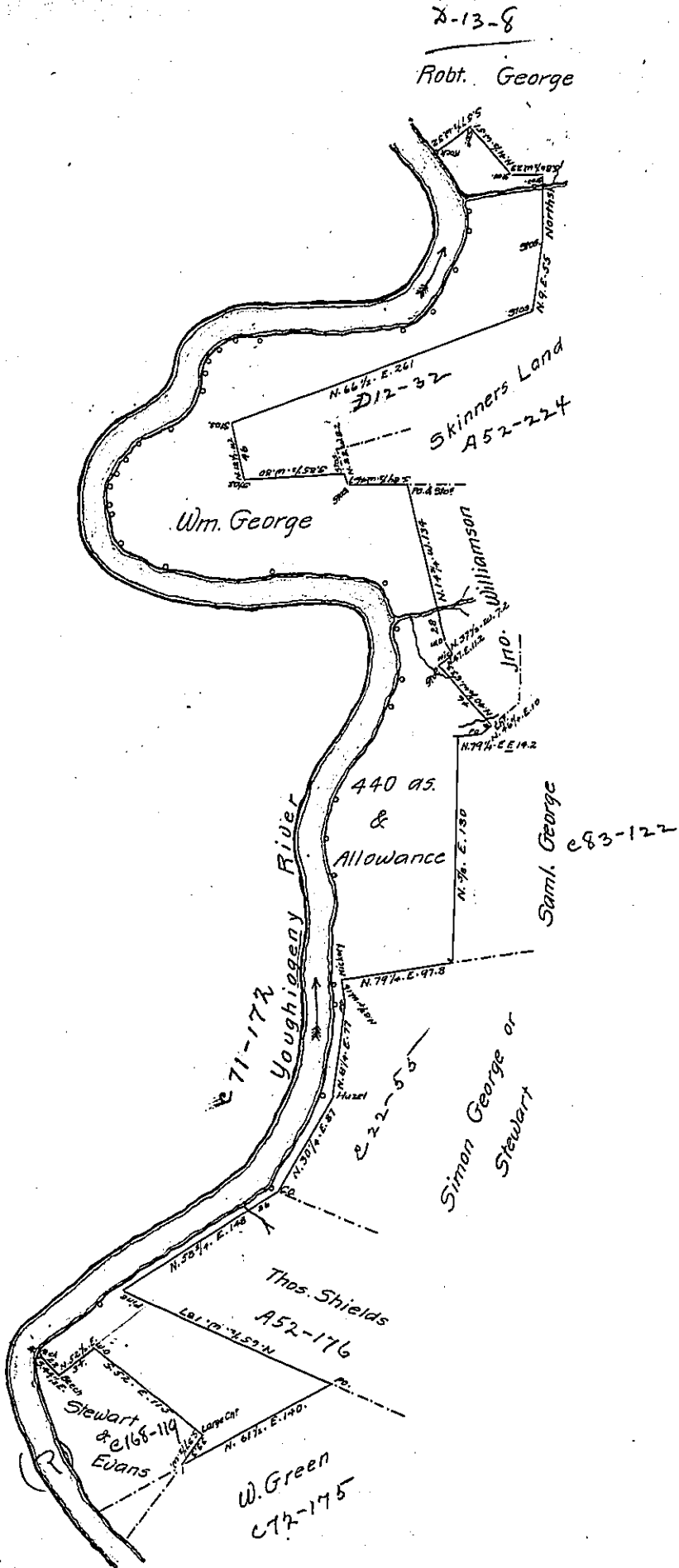

Situate on the east side of Youghiogey River in Saltlick township, Fayette county, and Surveyed the 20th day of August 1836 in pursuance of a warrant in the name of William George for 400as. dated the 30th. day of January 1794. There is no improvement on this tract.

William Griffith

This Survey was made by my Predecessor and appears to be correct
 To John Taylor Esqr. Surveyor General } Decr. 26, 1836.

IN TESTIMONY that the above is a copy of the original remaining on file in the Department of Internal Affairs of Pennsylvania, made conformably to an Act of Assembly approved the 16th day of February, 1833, I have hereunto set my Hand and caused the Seal of said Department to be affixed at Harrisburg, this
 third day of August 1905

Isaac B. Brown
 Secretary of Internal Affairs.